

CM40 Vandalproof Pushbutton



25mm

Ø 28mm

34.8mm

IP65

38.5mm

IP67

40.8mm

41mm

Specification

Termination	Screw or fast connect terminals (2.8x0.5mm)
Switching function	Momentary or maintained
Configuration of poles	Single or double
Maximum load	5A, 48VAC
Contact resistance	< 50 mΩ
Insulation resistance	> 1000 MΩ
Operating temperature	-20°C to +55°C
Ingress protection	IP67 (EN 60529) maintained: IP65
Duty cycle	50,000 (min)
Operating force	5.5N
Nut mounting torque	~ 0.8Nm
Panel thickness	1.0 to 10.0mm
Body & button material	See ordering information
Contact material	Gold plated

Product Dimensions

2.8mm terminals momentary

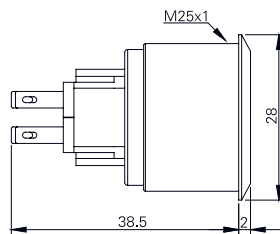

2.8mm terminals maintained

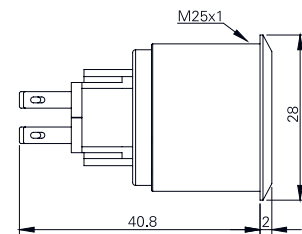

Screw terminals momentary

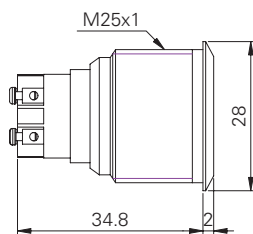

Screw terminals maintained

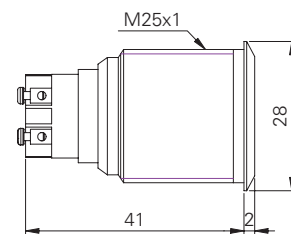

Front view (all versions)

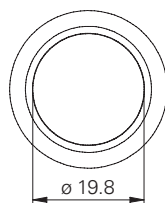

All dimensions in mm

CM40 Vandalproof Pushbutton

Circuit Diagram

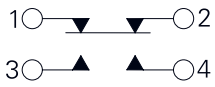

Form Z

Mounting Dimensions

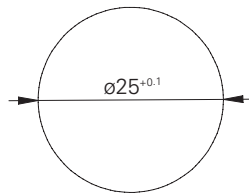

Contact arrangement

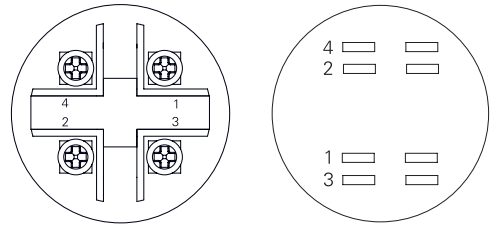

All dimensions in mm

Ordering information

Material

- V2:** Stainless steel¹
- AS:** Aluminium black

Switch Function

- M:** Momentary
- L:** Maintained²

Poles

- S:** Single
- D:** Double

Termination

- 28:** 2.8mm tabs
- ST:** Screws

CM40/ [] /F/ [] / [] / []

¹ 1.4301

² IP65 (EN60529)

Non rotating button available on request



Engelking Elektronik GmbH

Albstr. 16 · D-78609 Tuningen · Germany
Tel. +49 (0)7464-9865-0 · Fax +49 (0)7464-9865-71
info@engelking.de · www.engelking.de



Only certain variants.
See file number E504292 for details